

1 2 3 4 5 6 7 8

REV	LOCATIONS	DESCRIPTION	DATE	REVISER	APPD
1	△	Update dimensional tolerances	28/APR/25	MATT	LEO

Electrical  
 Temperature Range—Operating: -25°C~+85°C  
 Material  
 Housing: PA66( UL 94V-0)  
 Applicable Terminal: FT25011  
 Mates With(Wafer): FWF25009,FWF25010Series.

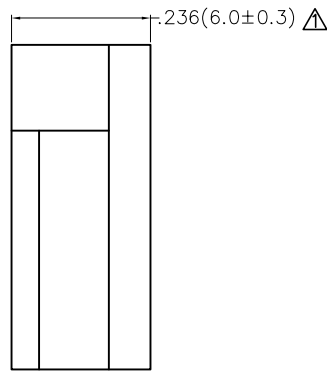
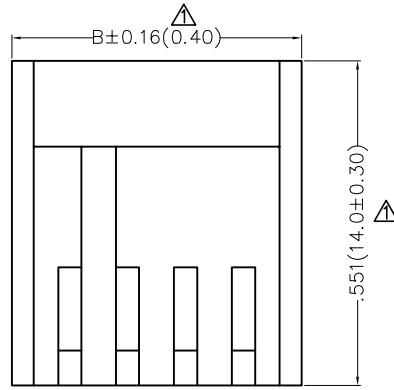
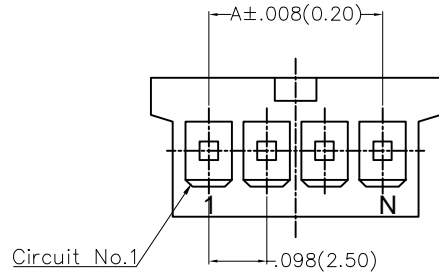

Circuits (n)	Part No.	Dimensions(in/mm)	
		A	B △
2	FHG25005-S02M2W1B	.098(2.50)	.280(7.10)
3	FHG25005-S03M2W1B	.197(5.00)	.378(9.60)
4	FHG25005-S04M2W1B	.295(7.50)	.476(12.10)
5	FHG25005-S05M2W1B	.394(10.00)	.575(14.60)
6	FHG25005-S06M2W1B	.492(12.50)	.673(17.10)
7	FHG25005-S07M2W1B	.591(15.00)	.772(19.60)
8	FHG25005-S08M2W1B	.689(17.50)	.870(22.10)
9	FHG25005-S09M2W1B	.787(20.00)	.969(24.60)
10	FHG25005-S10M2W1B	.886(22.50)	1.067(27.10)

Ordering Information

FHG 250 05 — S XX M 2 W1 B  
 1 2 3 4 5 6 7 8 9

1 Category FHG-Housing	2 Series Number 250-Pitch2.50mm	3 Distinction No. 05	4 Row Option S-Single Row	5 Circuits XX
6 Entry Type M-Male	7 Material-Resin 2-PA66	8 Color-Resin W1-White	9 Packaging B-PE Bag	

THIRD ANGLE PROJECTION	GENERAL TOLERANCES (UNLESS SPECIFIED)		APPROVE BY FRANK	DATE 25/JUL/13	PART NO. FHG25005-SXXM2W1B	ITEM NO. FHG25005	 Building Technology Cornerstone
	DESIGN UNITS Inch (metric)	X.±.012(0.30) X.X±.008(0.20)	X.*±5° .X*±2°	CHECKED BY JACOB	DATE 25/JUL/13	TITLE Wire to Board Pitch 2.50mm(Housing)	
SCALE 5:1	SIZE A4	X.XX±.006(0.15) X.XXX±.004(0.10)	.XX*±1° .XXX*±0.5°	DRAWN BY CHERRY	DATE 25/JUL/13	THIS DRAWING CONTAINS INFORMATION THAT IS PROPRIETARY TO TXGA INDUSTRIAL ELECTRONICS(S.Z)CO.,LTD AND SHOULD NOT BE USED WITHOUT WRITTEN PERMISSION	

1 2 3 4 5 6 7 8